

REVISIONS				
REV.	DATE	DESCRIPTION	ECO	BY
A	03/14/2007	RELEASE FOR PRODUCTION	11562	RLH

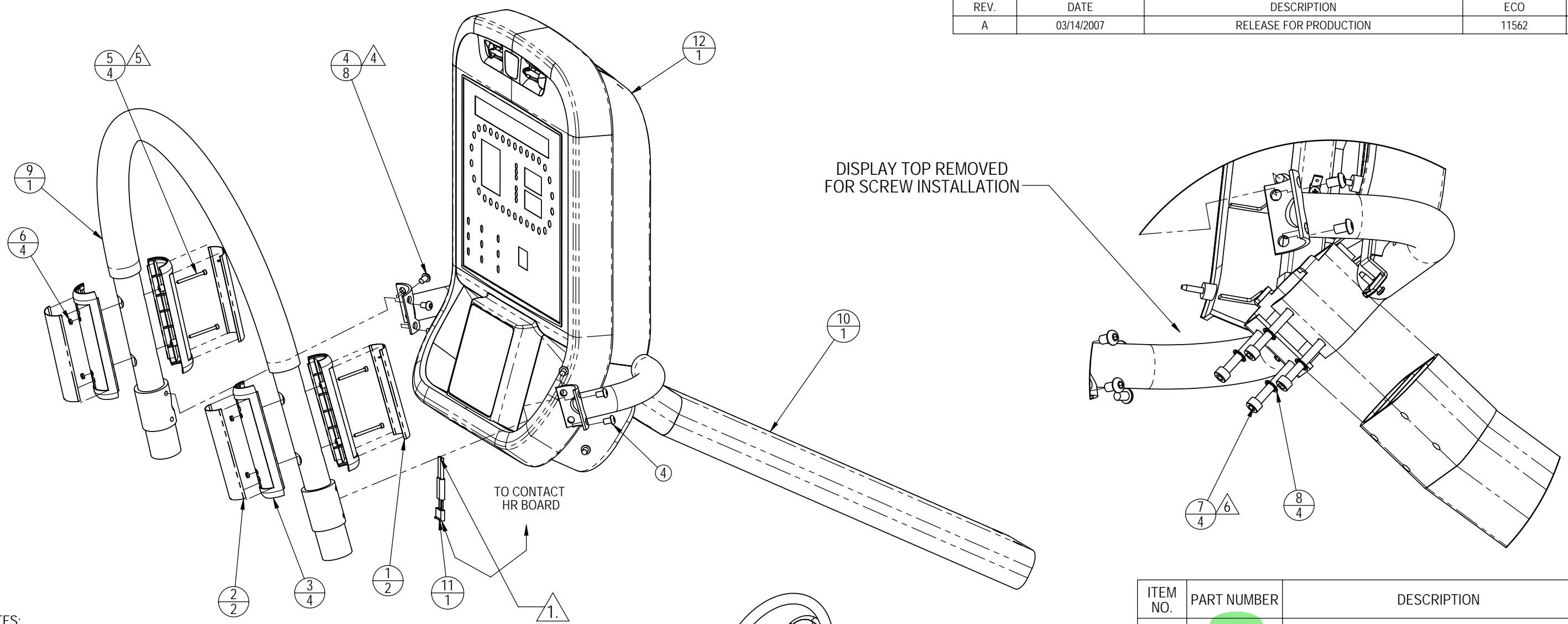

NOTES:

- 1. SEE SHEET #2 FOR WIRING DIAGRAM OF 711-3153.
- 2. GRIP ASSEMBLY ORDER:
 PALM SIDE:
 a) INSTALL, NUT P/N: 110-3148.
 b) CLEAN PLATE RECESS AREA WITH ALCOHOL.
 c) PEEL PLATE TAPE LINER.
 d) REMOVE PLATE SCRATCH GUARD & PRESS PLATE TO GRIP HOUSING.
 e) CONNECTOR TAB MUST GO TOWARDS THE INSIDE END.
 FINGER SIDE:
 a) CLEAN PLATE RECESS AREA WITH ALCOHOL.
 b) PEEL PLATE TAPE LINER.
 c) REMOVE PLATE SCRATCH GUARD & PRESS PLATE TO GRIP HOUSING.
 d) CONNECTOR TAB MUST GO TOWARDS THE OUTSIDE END.
- 3. PERFORM A CONTINUITY TEST AFTER INSTALLING THE CONTACT HR CABLE.
- 4. APPLY 110 lb-in / 9.2 lb-ft / 12.4 N-m OF TORQUE TO SCREWS (110-0506).
- 5. APPLY 4 lb-in / 0.5 N-m OF TORQUE TO SCREWS (110-3147).
- 6. APPLY 240 lb-in / 20 lb-ft / 27.1 N-m OF TORQUE TO SCREWS (110-3169).

**DOCUMENT STATUS:
RELEASE**

NOTICE OF PROPRIETARY INFORMATION
THIS DOCUMENT SHALL NOT BE REPRODUCED NOR
SHALL THE INFORMATION CONTAINED HEREIN BE
USED BY OR DISCLOSED TO OTHER EXCEPT AS
EXPRESSLY AUTHORIZED BY UNISEN

ITEM NO.	PART NUMBER	DESCRIPTION	QTY.
1	020-6549	PLATE, HR, BOTTOM	2
2	020-6555	PLATE, HR, UNIVERSAL, TOP	2
3	020-6556	GRIP, HR, UNIVERSAL, BLK	4
4	110-0506	SCREW, 1/4-28x3/8, BHC, HK, SS, BO	8
5	110-3147	SCREW, M3x35, SHC, ISO4762	4
6	110-3148	NUT, M3, HEXAGON, ISO4762	4
7	110-3169	SCREW, M6x65, SHC, HE, ISO4762	4
8	120-3257	WASHER, M6, TEETH, 0.6 THICK	4
9	710-1066-05	TUBE, TOP, DIPPED, STEPPER	1
10	711-3139-05	ASSY, STEP, FRONT, EXT, TOP	1
11	711-3153	ASSY, HR GRIP CABLE, STEPPER	1
12	711-3210	ASSY, DISPLAY LED & WELDMENT, E-ST	1

MATERIAL SEE BOM		TOLERANCES UNLESS OTHERWISE SPECIFIED X.XXX = ± .010" (0.25MM) ANGLES = ± 2° X.XX = ± .030" (0.76MM) FRACTIONS = ± 1/32 X.X = ± .050" (1.27MM) X. = ± .125" (3.20)		UNISEN, INC. DBA STAR TRAC 14410 Myford Road Irvine CA 92606	
FINISH SEE BOM		INITIAL DRAWN JRT	DATE 02-06-07	PART NO. 711-3197	REV A
VENDOR: N/A		P/N: N/A		TITLE ASSY, CONSOLE/HNDLBAR, E-ST	
		U.O.M. INCH		SCALE: 1:5	SHEET 1 OF 2 SHEET SIZE: B

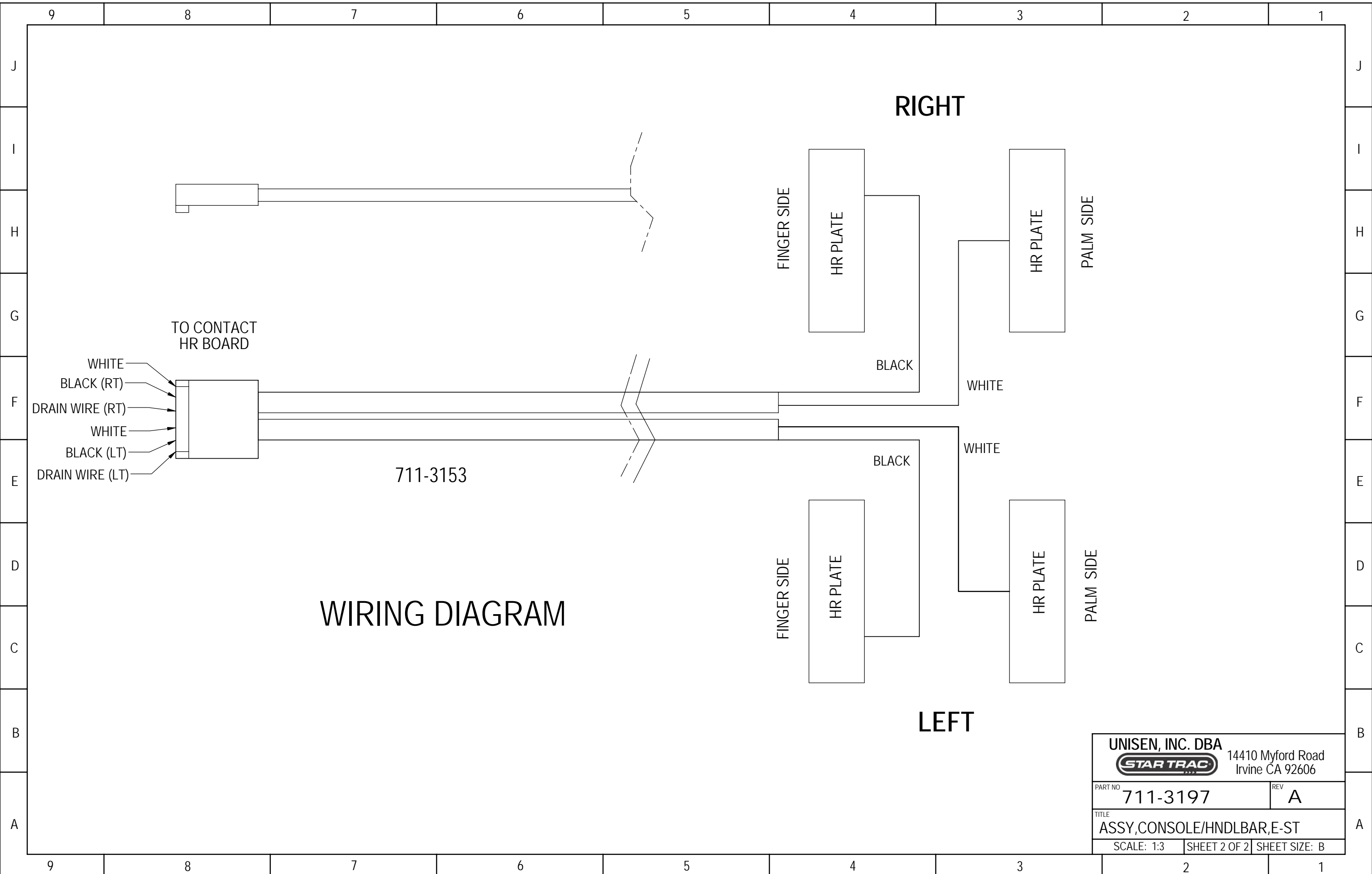

WIRING DIAGRAM

711-3153

TO CONTACT
HR BOARD

- WHITE
- BLACK (RT)
- DRAIN WIRE (RT)
- WHITE
- BLACK (LT)
- DRAIN WIRE (LT)

RIGHT

FINGER SIDE
HR PLATE
BLACK
HR PLATE
PALM SIDE

LEFT

FINGER SIDE
HR PLATE
BLACK
HR PLATE
PALM SIDE

UNISEN, INC. DBA		14410 Myford Road Irvine CA 92606	
PART NO	711-3197	REV	A
TITLE ASSY, CONSOLE/HNDLBAR, E-ST			
SCALE: 1:3	SHEET 2 OF 2	SHEET SIZE: B	